



# TONISCO® Hot Tapping Valves

DN20 - DN100 , PN25  
DATA SHEET



TONISCO® Hot Tapping Valves  
1220.0200-1220.1000

## Description and Features

TONISCO® Hot Tapping Valves are designed to create new branches to weldable district heating and cooling lines and to pipelines in process plants while the network is operating. A sluice plate acts as a temporary closing mechanism in order to remove the drilling device after the hot tapping and to connect the new branch.

### Main Features:

- Perfect for underground installations as the valve becomes a "piece of pipe" after the groove of the sluice plate has been welded
- Very low weight results in an easy handling on side
- Very short valve length for narrow sides

## Specifications

| 1.                         | TONISCO Hot Tapping Valve                                                     |
|----------------------------|-------------------------------------------------------------------------------|
| Sizes                      | DN20 - DN 100                                                                 |
| Drilling Valve Type        | Full Bore                                                                     |
| Product Number             | 1220.0200 - 1220.1000                                                         |
| Material Specifications    | Structural Steel S355J2 according EN 10025                                    |
| Sealing Material           | EPDM                                                                          |
| Nominal Pressure           | PN 25                                                                         |
| Max. Operating Temperature | 160 °C                                                                        |
| Area of Use                | Weldable District Heating and Cooling Lines, Weldable Lines in Process Plants |
| Applicable Fluids          | Hot or cold water                                                             |
| 2.                         | Welding / Branch Reinforcement Ring *                                         |
| Sizes                      | DN20 - DN 100                                                                 |
| Product Number             | 1223.0200-1223.1000                                                           |
| Material Specification     | Structural Steel S355J2 according EN 10025                                    |
| 3                          | Sluice Plate **                                                               |
| Sizes                      | DN20 - DN 100                                                                 |
| Product Number             | 1221.0200-1221.1000                                                           |
| Material Specification     | AISI 1074, W.-Nr. 1.1248                                                      |

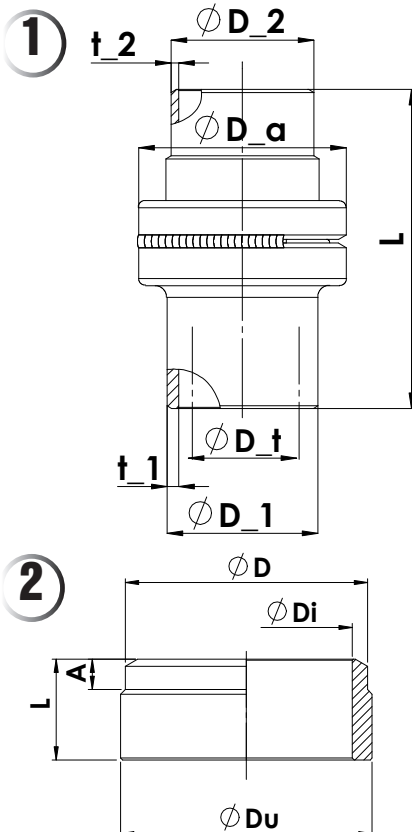
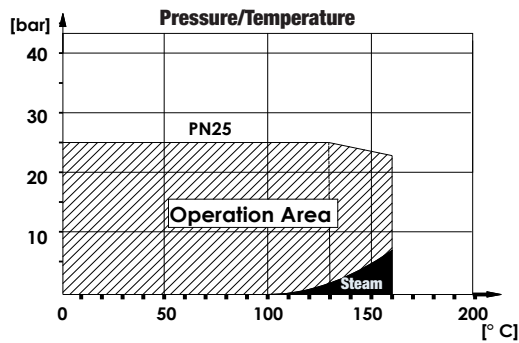

| DN  | Ø D_1 [mm] | t_1 [mm] | Ø D_2 [mm] | t_2 [mm] | L [mm] | Ø D_t [mm] | Ø D_a [mm] | Weight without sluice plate [kg] |
|-----|------------|----------|------------|----------|--------|------------|------------|----------------------------------|
| 20  | 30         | 4,2      | 26,9       | 2,6      | 140    | 21,6       | 68         | 1,25                             |
| 25  | 35,9       | 4,3      | 33,7       | 3,2      | 138    | 27,3       | 68         | 1,10                             |
| 32  | 45,0       | 4,5      | 42,4       | 3,2      | 140    | 36         | 78         | 1,55                             |
| 40  | 50,9       | 4,5      | 48,3       | 3,2      | 138    | 39         | 78         | 1,50                             |
| 50  | 63,9       | 5        | 60,3       | 3,2      | 135    | 46         | 88         | 1,60                             |
| 65  | 78,9       | 5        | 76,1       | 3,6      | 145    | 60         | 105        | 3,00                             |
| 80  | 92,9       | 6        | 88,9       | 4        | 155    | 71         | 117        | 3,80                             |
| 100 | 120,3      | 7,5      | 114,3      | 4,5      | 175    | 100        | 148        | 5,45                             |

\*A reinforcement of the branch might be necessary in addition to the TONISCO Valve, depending on the size of the main line, system pressure, system temperature etc.. The piping planner has to decide whether a nozzle reinforcement is necessary or not.

\*\* The sluice plate should not stay in the pipeline network for longer than 2 weeks. It is recommended to reduce the system pressure during the operation to maximum 12 bar.

| DN  | Ø D [mm] | Ø Di [mm] | Ø Du [mm] | L [mm] | A [mm] | Weight [kg] |
|-----|----------|-----------|-----------|--------|--------|-------------|
| 20  | 30       | 21,7      | 33,7      | 50     | 15     | 0,18        |
| 25  | 35,9     | 27,3      | 39,3      | 50     | 15     | 0,22        |
| 32  | 45       | 36,0      | 49        | 50     | 15     | 0,31        |
| 40  | 50,9     | 41,9      | 54,5      | 50     | 15     | 0,34        |
| 50  | 63,9     | 53,9      | 67,5      | 50     | 15     | 0,47        |
| 65  | 78,9     | 68,9      | 82,5      | 50     | 15     | 0,58        |
| 80  | 92,9     | 80,9      | 95        | 50     | 15     | 0,73        |
| 100 | 120,3    | 105,3     | 125       | 60     | 15     | 1,57        |

