

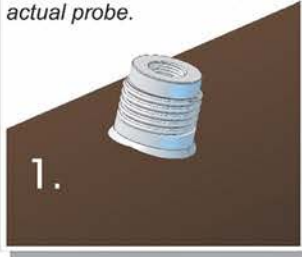

TONISCO AA11

Procedure

To a desired spot a TONISCO nipple is welded electrically. The outer thread fits to the drilling device and the inner thread is for connecting the actual probe.



1.

TONISCO closing valve shall then be connected to the outer thread of the nipple. The valve is very easily serviceable ranging between temp. 0-180 C at 0-60 bar.

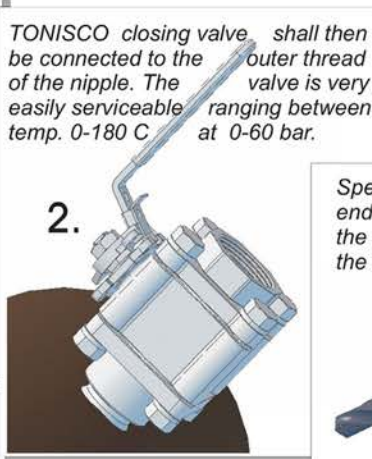

2.

Special drill is attached to the end of Jr.- drilling device and the equipment is mounted for the drilling.



3.

TONISCO Jr. drilling device is attached to the drilling valve and the drilling is made under pressure.

To prevent long chip forming the feed must be eased at regular intervals.

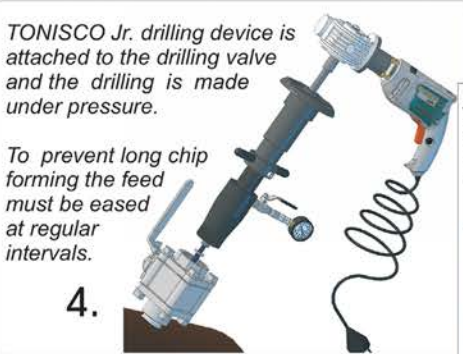

4.

After completing the hole the shaft must reverse to out- position to close the drilling valve by turning the lever to closed position.

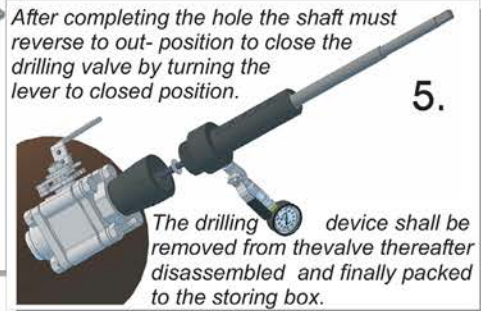

5.

The drilling device shall be removed from the valve thereafter disassembled and finally packed to the storing box.



6.

The pocket of the temperature gauge with the copper plate and some Teflon tape covering the thread is first connected to the installing shaft and thereafter they are pushed into the installing tube.

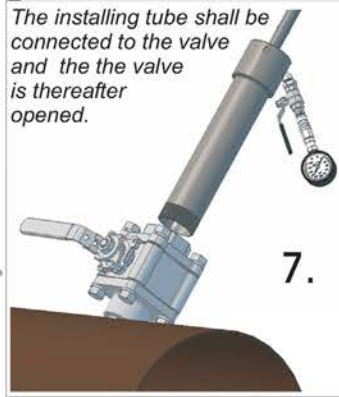

The installing tube shall be connected to the valve and the valve is thereafter opened.

7.

By simultaneously rotating and pressing the shaft in the pocket shall be wound to the thread of the nipple.

The tightness of the connecting thread is controlled by opening carefully the control valve.



8.

Prior to the final tightening, all the remaining drilling waste between the surfaces will be removed using the cleaning brush.

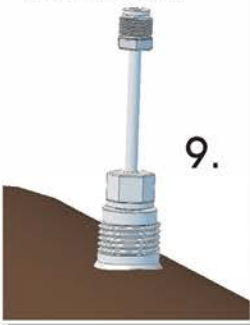

9.



10.

The actual measuring device can now be installed into the pocket and the wires shall be connected

This way the installation of Pt100 is carried out without interrupting the flow inside the pipe.

When the connection is tight, the installing tube is removed and the shaft loosened.

TONISCO® AA11

For under pressure installations of PT100 Temperature Sensors



Description

TONISCO A11 machines are designed for installing the PT100 Temperature Sensors to pipelines without causing interruptions to the system. Using the A11 equipment it is possible to make the most of repair alteration or service works under pressure.

To avoid any production losses during such cases TONISCO has developed a simple method of how to make the assembly of a PT100 pocket under pressure without disturbing the on going process.



Features

In most industrial processes, power plants and district heating networks the PT100 temperature sensors are widely used to monitor the operating temperatures. The whole process is often forced to be shut down to assemble a new pocket or to replace an existing pocket for the temperature sensor.

TONISCO A11 machine is add-on equipment for TONISCO JR Hot tapping machine and can be used with the same drive units as the TONISCO JR Hot tapping machine.





TONISCO AA11

Under pressure installations of PT100 Temperature Sensors

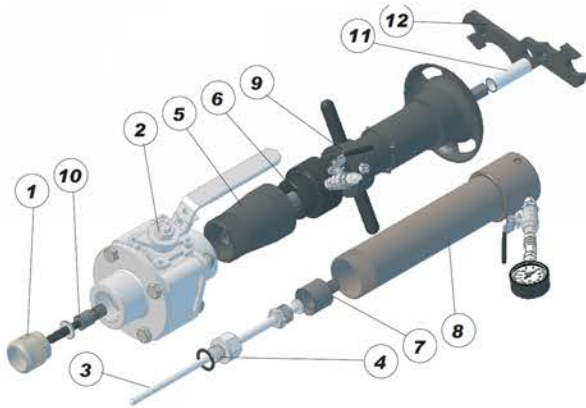

Product Name

Item no.

1.Welding nipple 1/2	1260.0150
2.AA inst. Valve 2"	1260.0400
3.PT100 pocket 160	1260.6160
4.Sealing 1/2"	1837.0480
5.Adapter 2" OG	1222.0500
6.Jr. Drill shaft 595	1229.0050
7.Pocket chuck	1260.0050
8.AA inst. Tube 300 compl.	1260.0300
9.Tonisco Jr. compl.	1228.0000
10.Jr. AA drill 12	1260.0012
11.Jr. Ext. socket	1227.0000
12.Jr. Multi-Wrench	1250.0170
Accessories	
Manometer set	1273.0000
Tonisco Cutting Paste	1289.0010
Tonisco Sealant Lubricant	1269.0010
Teflon Ribbon	1850.0030